

- PHASE 5**
1. FENCE, GATE, SIGNAGE INSTALLATION, ETC..
 2. WIRE MODULES
 3. WIRE MANAGEMENT
 4. DECOMPACTION, REGRADING, AND RELOAMING AREAS USED TEMPORARY ROAD, LAYDOWN, ETC., FOR DURING CONSTRUCTION
 5. SPREADING TOPSOIL
 6. INSTALLATION OF FINAL IMPERVIOUS ACCESS ROAD AND MAINTENANCE OF EXISTING ROAD (SEE SITE PLANS FOR LOCATION)
 7. FINAL SEEDING
 8. REMOVAL OF EROSION AND SEDIMENT CONTROL FEATURES ONCE >80% STABILIZATION HAS BEEN ACHIEVED.

MAXIMUM DISTURBANCE: ±2.20 ACRES

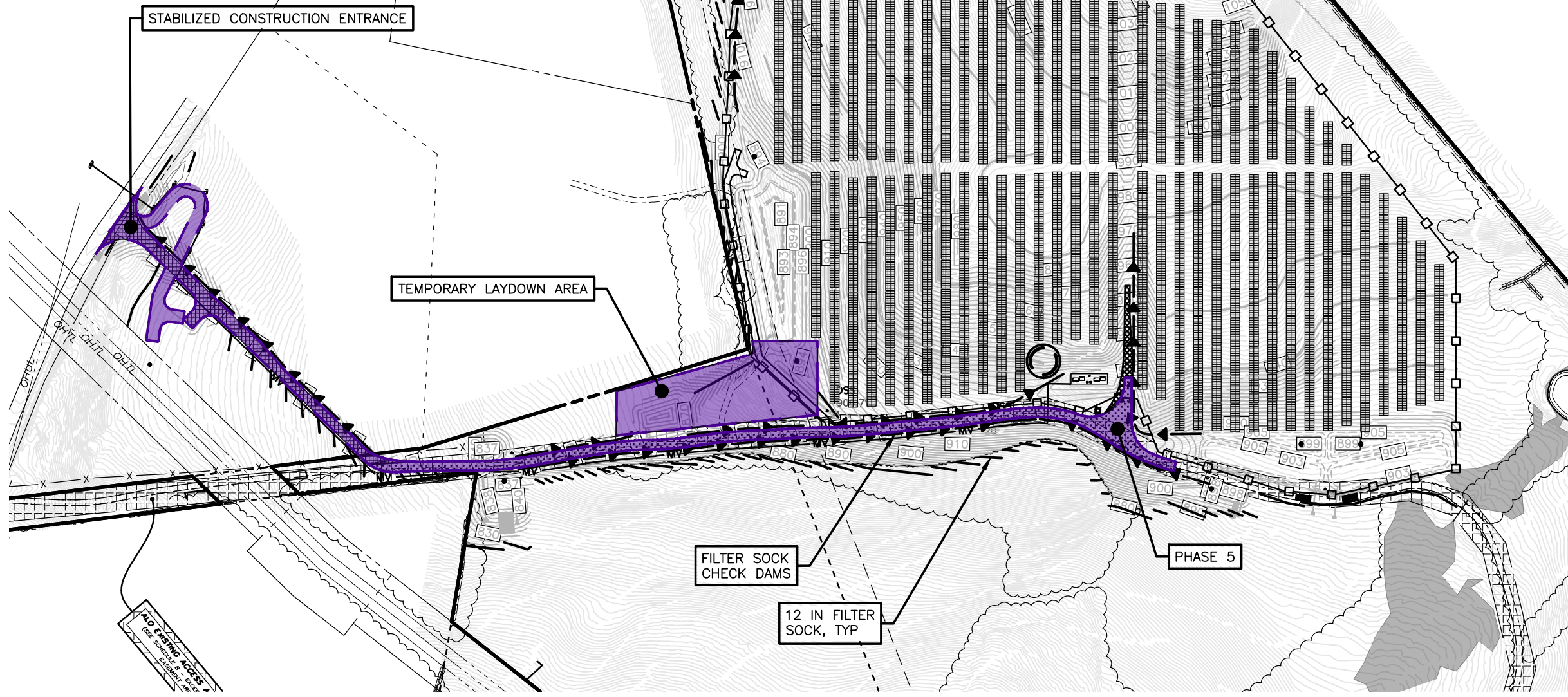

PHASE 5 DISTURBANCE
SCALE: 1"=200'

C:\WORKFILES\Environmental Design Partnership\Sharepoint Site - Documents\01-2023\SECTIONS\SECTION\Wilson Hill Road\469 - Nexamp Solar\05-dwg\05-dwg.dwg\05-dwg.dwg Sep 18, 2023 10:50:09AM

101 Summer Street, Boston, MA 02110
Tel: (617) 431-1440 Fax: (978) 416-2525 Web: nexamp.com

ENVIRONMENTAL DESIGN PARTNERSHIP, LLP.
300 Route 146 Clifton Park, New York 12565
(518) 371-1621

Rev	Issued For	Date

P.E. seal/Consultant

Project:
WILSON HILL SOLAR
469 Wilson Hill Road
Hoosick Falls, NY 12090

Drawing Title:
DISTURBANCE PHASING PLAN
NOT FOR CONSTRUCTION
Drawn by: BMW Scale: As Shown Approved by: STA

Dwg No: PH 2 Size: D Sheet Rev:

FOR MUNICIPAL APPROVAL ONLY - NOT INTENDED FOR CONSTRUCTION

Company Confidential - This drawing or print is the property of Nexamp, Inc. and is subject to return on request. The design concepts and information contained herein are proprietary to Nexamp, Inc. and its subsidiaries and are submitted in confidence. They are not transferable and must be used only for the purpose for which the Drawing/print is expressly loaned. They must not be disclosed, reproduced detrimental to the interest of Nexamp, Inc. All patent rights are reserved unless they are expressly assigned in writing by a duly authorized representative of Nexamp, Inc.